

Listed buildings of special architectural or historical interest

(Only those buildings within the area of the Broadland District Council – Reepham Local Plan are included)

1. The Cardinals Hat, Back Street (Grade II)

House with C16 jettied timber frame section, extended in the early C17 in diapered brickwork, with rear late C17 double pile extension, all of 2 storeys. The brick was rendered and colourwashed about 1975.

2. Nelson House, Back Street (Grade II)

House, early C18 extended with early C19. Red brick, colourwashed brick with pantile roof. Now divided into two cottages. 2 storeys, with 2 storey and single storey outbuildings to the south, which are not of special interest.

3. Oak Leaf House and Acorn Cottage and adjoining cottage to east, Back Street (Grade II)

House, early C18, red brick and colourwashed brick with pantiled roof. The house of 2 storeys and attics, with rear out-shut has been divided and extended to form 3 terraced cottages. C20 flat roofed extension at rear. Included for group value.

4. The Old Shop, Back Street (Grade II)

Former Shop, Late C17, much altered in the C19. Built of red brick, rendered at ground floor level with red pantiled roof. Terraced, 2 storey and attic, with C19 single storey wing to the south. C17 beams in living room with ogee stops. Included for group value.

5. The Oaks, Back Street (Grade II)

Farmhouse of C17, added to and altered in the C18 and late C19. Built of red brick, gault brick and slate. 'L' shaped plan of 2 storeys with rear 2 storey lean-to. Late C19 terraced street façade of 3 windows with off centre door. Sash windows have shutters at ground floor.

6. The Old Bakehouse, Back Street (Grade II)

House, C18, of red brick with pantile roof. End of Terrace, 'L'-shaped plan of 2 storeys and attics. Included for group value.

7. The Greyhound (brick arch), Back Street (south) (Grade II)

Former public house, C17, but much altered. Built of red brick and rough cast brickwork with pantiled roof. 'L'-shaped plan of 2 storeys. Late C19 public house partitions, screens, doorways and details remain intact. Included for group value.

8. Church of All Saints (fragment), Church Hill (Grade II)

Remaining wall of the Parish Church of All Saints, Hackford, destroyed by fire in 1543. Tower taken down in 1790. Of flint and brick with, to the west, a 2 centred blocked arch.

9. Church of St. Michael and All Angels (formerly listed as Church of St. Michael), Church Hill (Grade II*)

Parish Church of Hackford with Whitwell, the nave converted to Parish rooms. Mainly C14 and C15. Flint with stone quoins. Brick and flint additions. Roof of slate and plain tiles. Tower, nave, modern extension to north. Red brick link to St. Mary's Church. Fine Jacobean pulpit, restored 1893.

10. Church of the Nativity of St. Mary with brick retaining wall to the north (formerly listed as Church of St. Mary), Church Hill (Grade I)

Parish Church, mainly C14, with a major restoration in 1885. Built of flint with stone quoins and black glazed pantile roof. Nave, north aisle, south porch, south tower. south aisle and chancel. 2 stage tower with stepped diagonal buttresses. On the north wall a fine monument, probably William de Kerdeston, died 1361. Churchyard, raised above Church Hill, and retained by red brick wall to north, with raking buttresses, and attached to the north aisle wall.

11. Post Office, House of Reverend Easton. Oakdene and Church Hill House, Church Hill (Grade II)

Corner shop and 3 terraced houses. 'L'-shaped plan. 2 storeys with rear outshuts. Red brick. colourwashed brick and slate roofs.

12. The Thatched Cottage, Church Hill (Grade II)

House, C17, red brick and thatch. 1½ storeys to rear lean-to, divided into cottage and shop. Included for group value.

13. Magpie House, Church Hill (Grade II)

House and shop, of mid C19 of red brick and pantiles. 'L'-shaped, 2 storeys, with single storey additions to the north and east. Included for group value only.

14. Wavy Line Food Fare, Church Street (north) (Grade II)

Shop, early C19, of red brick. colourwashed, with pantile roof. 2 storeys, 5 windows to street. On ground floor mid C19 door and shop front . Included for group value only.

15. Rookery Farm House and Cart Shed, Church Street (Grade II)

Farmhouse, circa 1810, of red brick with smut pantile, red pantile and slate roofs. 'L'-shaped plan of 2 storeys. Attached to the west a 4-bay cart shed and granary of 2 storeys, with curved timber lintels supporting segmental brick arches. Linked to this a high rendered brick wall. Cart shed and wall included for group value.

16. Rookery Farm Barn, Church Street (Grade II)

5 stead barn, dated 1810 of red brick and red and black pantiles. 2 pairs of barn doors on south face. Flagstone threshing floor.

17. Church Wall to south of St. Mary's Church, Church Street (Grade II)

C19 and earlier wall of red brick and flint, retaining the eastern and southern boundaries of the Churchyard from the east entrance to the Church Hall. For half its height, in flint and stone, then in brick, with a brick saddle back coping on the eastern section, and a stone coping on the western section.

18. York House, Church Street (Grade II)

House, C17, rough cast brick, red brick, possibly with timber framing. Pantile roof with parapet gable to west, 2 storeys and attic with northern outshut, and lean-to extensions at north and south.

19. Boundary Wall, The Old Rectory, Church Street (Grade II)

Boundary wall and gates. of two periods, the first to the south, C18, and second, C19. from a point to the south of the entrance to the property boundary to the north.

20. The Old Rectory, Church Street (Grade II)

Former rectory of Reepham with Kerdiston, 1864, by Henry Goddard of Lincoln. Of polychrome brickwork with slate roof. Included for group value.

21. Eynesford House, Dereham Road (Grade II)

Doctors house, circa 1848, of red brick and black pantiles. Double pile hipped roof of 2 storeys. with rear gabled service wing. 2 storey lean-to waiting room, and linked Tack Room and 2 storey coach house.

22. The Laurels, Dereham Road (Grade II)

House, circa 1837 of red brick, rendered brick, colourwashed, with slate roofs. Of 2 storeys with lean-to extension at rear.

23. The Stores and adjoining house to the west, Market Place (Grade II)

Terraced house and shop, mid C18, of red brick and black pantiles. 'L'-shaped plan of 2 storeys and attics with 2 storey range and lean-to basement range at rear.

24. Ewings and adjoining house to the east, Market Place (Grade II)

Terraced shop and house, the shop now an office. Late C18, of red brick with pantiled roof. 'L'-shaped plan of 2 storeys and attics. Included for group value.

25. Barclays Bank, Market Place (Grade II)

House, now bank and offices. Early C19 of red brick and slate. 3 storeys with 'L'-shaped plan.

26. Hawk Lifting Services (adjoining Barclays Bank to the north), Market Place (Grade II)

Semi-detached house converted to office, C18, of red brick and pantiles. 'T'-shaped plan, of 2 storey and attic. Included for group value.

27. Attfields Butcher Shop, Market Place (Grade II)

Shop, C17, of brick and red pantiles. 2 storeys and attics. Façade to Market Place with C20 shop front. Included for group value.

28. The Chimes, Antiques, Market Place (Grade II)

House and shop, early C18, of rendered brickwork with black pantiled roof. 2 storeys and attics with rear lean-to. C19 double shop front to left with central half glazed doors and fanlight.

29. The Old Brewery House, gates and railings (formerly listed as Dial House), Market Place (Grade II)

Former house and brewery buildings, now a hotel. Early C17 core, to south west, rebuilt and extended in early C18, forming 'L'-shaped plan of 2 storeys and attics. C19 wing, set back on west, of 'T'-shaped plan attached to front range. Substantial extension, circa 1900, behind front range. Modern extensions on east and west, linking converted maltings forming an open courtyard to the north, all of 2 storeys (of no special interest). Built of red brick with pantiled roofs.

30. The Old Bakery, Market Place (Grade II)

House, divided into two. C17, greatly altered in the early C19. Built of red brick with slate and pantiled roof. 'T'-shaped plan of 2 storeys and attics. South facade of 4 bays.

31. Carleton House, Melton House and railings, Market Place (Grade II)

2 terraced houses and shop. C18, re-fronted in mid C19. Red brick, rendered brickwork and black pantiles. 'L'-shaped plan with rear outshut. 2 storeys with rear range of 1½ storeys. Wrought iron railings with finials and central gate to Carleton House on brick wall with date stone dated 1884. Included for group value.

32. The Post Office, Market Place (Grade II)

Former house, now shop. Late C18, of red brick, colourwashed brick and black pantiles. 2 storey with rear outshut. C20 double shop front in centre. Included for group value.

33. Ivy House, Market Place, (Grade II)

House, converted to Solicitors offices and shop. C18, red brick, colourwashed and rough cast brick, with black pantile roof. 'L'-shaped plan, of 2 storeys and attic to Market Place and 3 storeys at the rear. Included for group value.

34. Iona House, Market Place (Grade II)

Terraced house converted to 2 shops and flat. Mid C19, colourwashed and rough cast brick with slate roof. 2½ storeys to Market Place with hipped, bow fronted extension, and, at rear, basement storey and lean-to extension. Double bow fronted shop front to Market Place. Included for group value.

35. No. 7 Market Place (Grade II)

Terraced house, C18, colourwashed brick with pantiled roof. 3 storeys. with rear and storey lean-to wing. Included for group value.

36. Kings Arms, Market Place (Grade II)

Former Inn, now public house. Early C18 with C16 brick fragments and C19 stables. Red brick, brick and flint and colourwashed brick with red and black pantiled roof. 2 storeys and attic. Stables for group value.

37. Breeze House, The Drapers, Hewkes House, Market Place (Grade II)

House, converted to flat, shop and house, circa 1840, with earlier core, and late C19 additions of red brick with slate and pantiled roofs. 'L'-shaped plan, 2 storeys and attics with rear lean-to additions. East west wing included for group value.

38. The Bircham Institute and boundary wall to west, Market Place (Grade II)

Former house, now library and community rooms. C17, and greatly altered in the C19. Built of red brick, colourwashed render with black pantile and slate roof. 'U'-shaped plan, of 2 storeys and attics, forming an open courtyard to the east. Facade to Market Place rendered. At rear, red brick wings with gabled pantile and slate roofs.

39. Riches Stores, Market Place (Grade II)

Shop and flat, mid C19, built of colourwashed, red brick with red and black pantiled roof. 2 storeys and attics with rear lean-to. Included for group value.

40. The Old Vicarage, Mill Road (Grade II)

Former Rectory circa 1840, of red brick with smut pantiled hipped roof, later remodelled and extended to the east.

41. Beaver House, Norwich Road (Grade II)

House and shops, early C19, of red brick and pantiles. 2 storeys. House and shop to left of 4 windows, with small shop, to the right. Many interior fittings intact.

42. The White House, Norwich Road (Grade II) House, mid C18, of stucco and white painted brick with slate roof. Square, 3 bay hipped pile, with hipped roof pile to the north west and linked gable range to the south west.
43. Echo Lodge, Ollands Road (Grade II) Former Lodge to the Ollands Country House, now demolished. C19, red brick with black pantiled roof. 1½ storeys with eastern lean-to, and C20 western staircase extension. Attached boundary wall to west with 2 centred arch and timber door with 'Y' tracery.
44. The Thatched Cottage, Reepham Moor (Grade II) House, late C17, of rendered brick and reed thatch. 2 storeys with rear outshut. 2 windows, 2 doors, late C20, in original opening.
45. Nos. 3 and 4 Ye Olde Monastery (formerly listed as Olde Monastery), Reepham Moor (Grade II) House, divided into two. Early C18 of red brick and pantiles. 'L'-shaped plan of 2 storeys and attics.
46. Moor Lodge, Reepham Moor (Grade II) House, C 18, of red brick and rendered brick with pantile roof. 2 storeys. with triple pile at rear. 3 window facade with central 4 panel part glazed door with cast iron 'Gothick' porch. Good cast iron fireplaces – a blacksmith was in residence in 1809.
47. Gate and garden wall, Moor Lodge, Reepham Moor (Grade II) Early C19. Red brick, wall adjoining the road, with cast iron coping and wrought iron railings. Central, set back wrought iron entrance gate. Included for group value with Moor Lodge.
48. Manor Farm House, Reepham Moor (Grade II) Farmhouse dated 1752, of red brick and black pantiles. 2 storeys with rear outshut. 3 bay facade with central door with C20 timber portico. C20 flat roofed rear extension.
49. Nos. 1, 3, 5 Townsend Corner, Station Road (Grade II) Shop, house and store. Mid C19 of red brick and smut pantiles. 'L'-shaped plan of 2 storeys, extended to the north. Included for group value.
50. Dairy Farm Barn, The Street, Whitwell (Grade II) Barn, dated end gable of 1735 of red brick and pantiles. 3 bay, with byre at south end. Southern gable re-built with bargeboard. Hipped roof byre not of special interest.

From an article published in the Reepham Society Newsletter, November 1987



MAP

LISTED BUILDINGS WITHIN AREA OF LOCAL PLAN

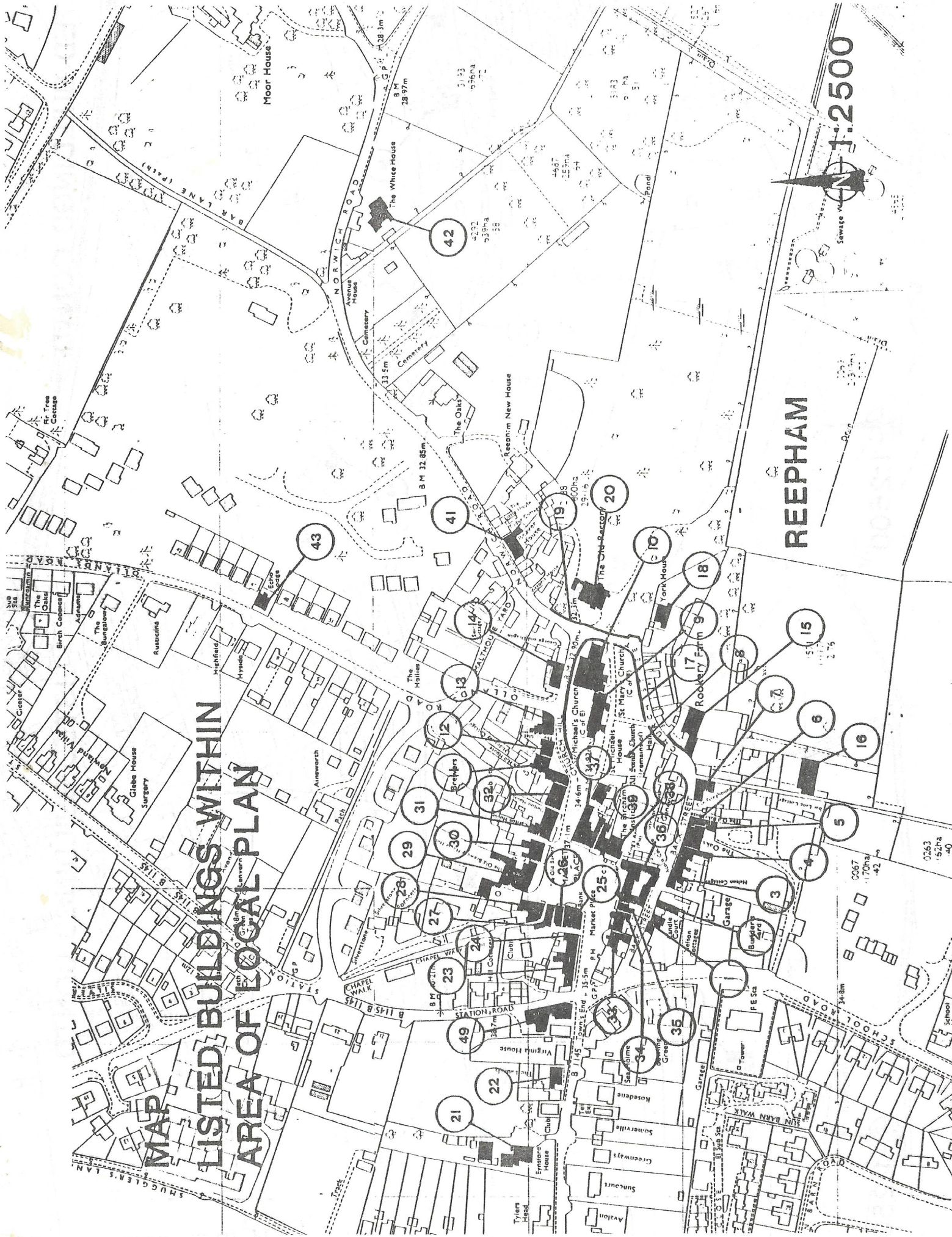

REEPHAM

LISTED BUILDINGS CONTD

LISTED BUILDINGS CONTD.

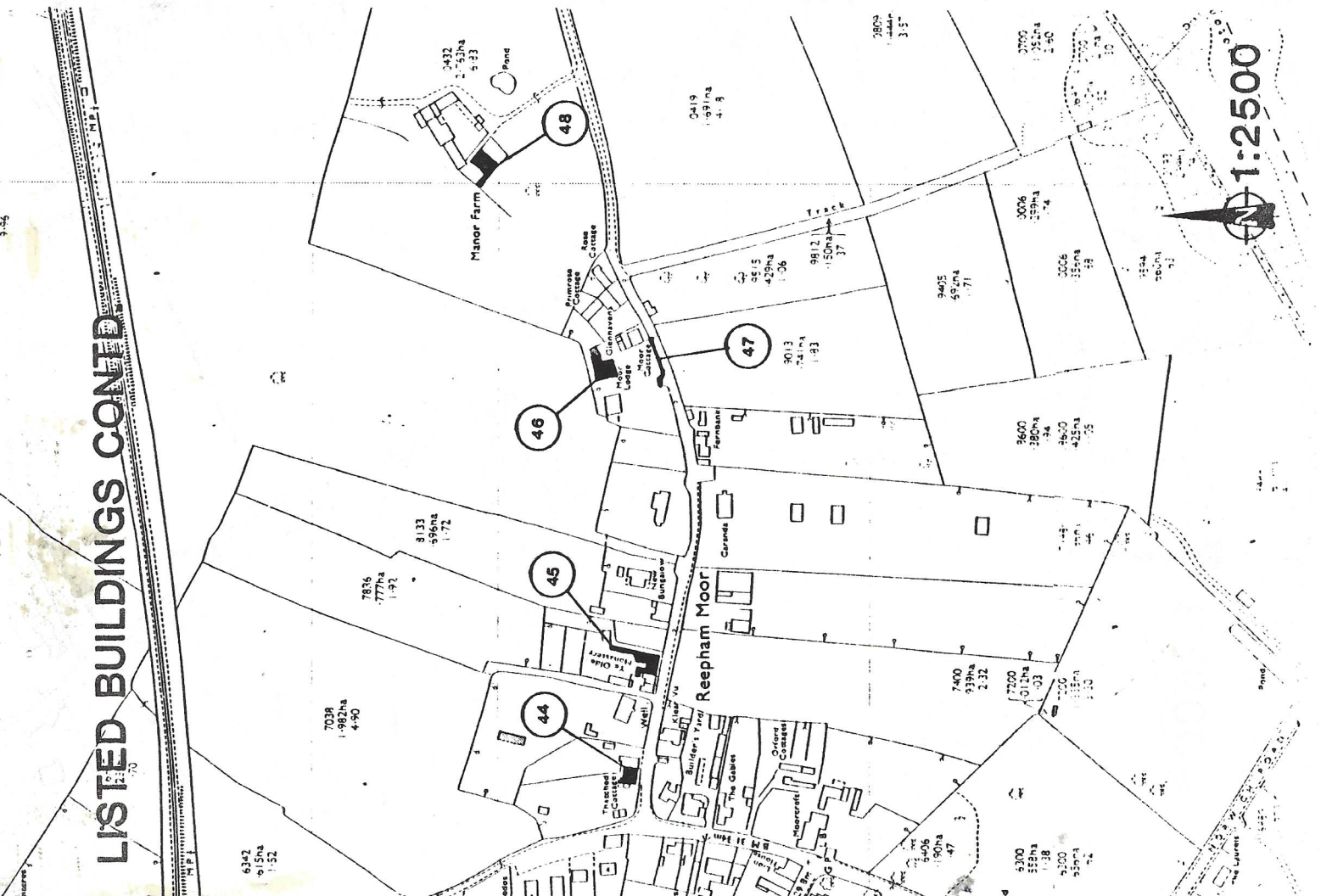

1:2500



1:2500